



8 Pigeon Lane, Herne Bay, Kent, CT6 7EH



3 BEDROOM MODERN SEMI-DETACHED HOUSE LOCATED ON THE SOUTH SIDE OF TOWN.....ELEVATED PLOT  
..GARAGE AT REAR IN BLOCK.....GAS C/HTG...DOUBLE GLAZING.... SOUTH FACING REAR GARDEN.... CAVITY  
WALL INSULATION...



**£289,950 Freehold**



## Enclosed Entrance Porch

Double glazed window. Double glazed door.

## Entrance Hall

Radiator. Cupboard understairs. Power points.

## Kitchen

10'7 x 8'8 (3.23m x 2.64m)

Stainless steel sink unit. Worktops. Wall cupboards. Stainless steel extractor hood. Gas hob. Electric oven. Recess for fridge. Recess for washing machine. Power points. Breakfast bar. Radiator. Tiled floor. Double glazed door to garden.

## Lounge/Diner

21'2 x 12' (at widest point) (6.45m x 3.66m (at widest point))

(Doors off hall and kitchen) 2x Radiators. Television point. Power points. Distance sea glimpses. Triple glazing to front window. Double glazed doors to rear garden.

## Landing

Access to roof space and ladder. Gas boiler in roof.

## Bathroom/WC

Panelled bath with independant shower unit over. Pedestal wash hand basin. Low level WC suite. Heated towel rail. Tiled walls. Tiled floor.

## Back Bedroom (south facing)

11'9 x 9' (3.58m x 2.74m)

Radiator. Power points.

## Front Bedroom

12' x 8'9 (3.66m x 2.67m)

Triple glazing. Built-in wardrobes. Linen cupboard. Some distant sea views.

## Front Bedroom

9' x 7'2 (2.74m x 2.18m)

Radiator. Power points. Built-in cupboard. Triple glazing. Some distant sea views.

## OUTSIDE

### Rear Garden

Elevated rear garden in lawn. Patio. Flower beds. Pedestrian rear access.

### Side Entrance

Shed. Hose tap. Possible garage space subject to planning permission.

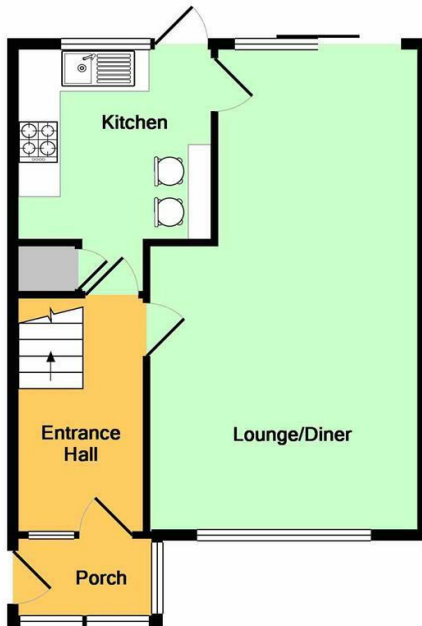

Ground Floor

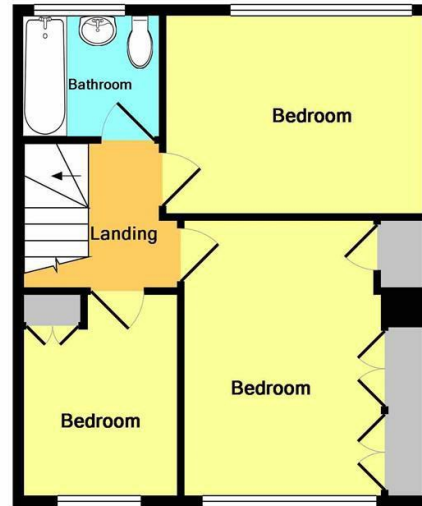

1st Floor

Whilst every attempt has been made to ensure the accuracy of the floor plan contained here, measurements of doors, windows, rooms and any other items are approximate and no responsibility is taken for any error, omission, or mis-statement. This plan is for illustrative purposes only and should be used as such by any prospective purchaser. The services, systems and appliances shown have not been tested and no guarantee as to their operability or efficiency can be given.  
Made with Metropix ©2019

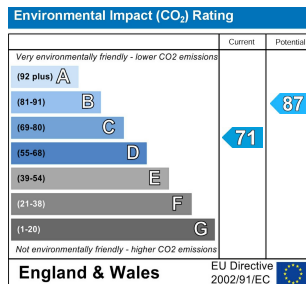
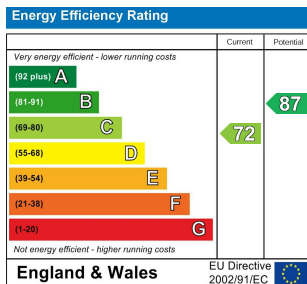

**Note:**

We have not tested the heating system, electrical appliances or the electric, gas and plumbing systems.

If travelling any distance to view this property it is advisable to check the availability and viewing times before hand. Wilbee & Son, as agents, cannot be held responsible for lost journey times and / or any expenses incurred.

These particulars are issued on the condition that any negotiations respecting the property are through Wilbee & Son. Every care is taken in giving particulars but should any error inadvertently occur or any property found to be previously withdrawn or disposed of, Wilbee & Son do not hold themselves responsible for any expenses or loss of time incurred. Neither the Vendor, nor the Partners or any employee of Wilbee & Son make or give any representation or warranty in relation to the property.

Oyster Financial Services is an appointed representative of Openwork Limited, which is authorised and regulated by the Financial Services Authority





# WILBEE & SON



**01227 374010**

[property@wilbeeandson.co.uk](mailto:property@wilbeeandson.co.uk)